

TOLERANCES acc. to ISO / TOLERANSEER entl. ISO
 Applicable where no tolerance is indicated.
 Guller dor tolerans ei direkt utsett.
 For machining / For bearbeiting ISO 2768-mk
 For welding / For sveiting SS-EN ISO 13920-BF
 Surface finish acc. to ISO 1502 Machine surfaces
 Ytjamhet enligt ISO 1302. For bearbeitede ytor.

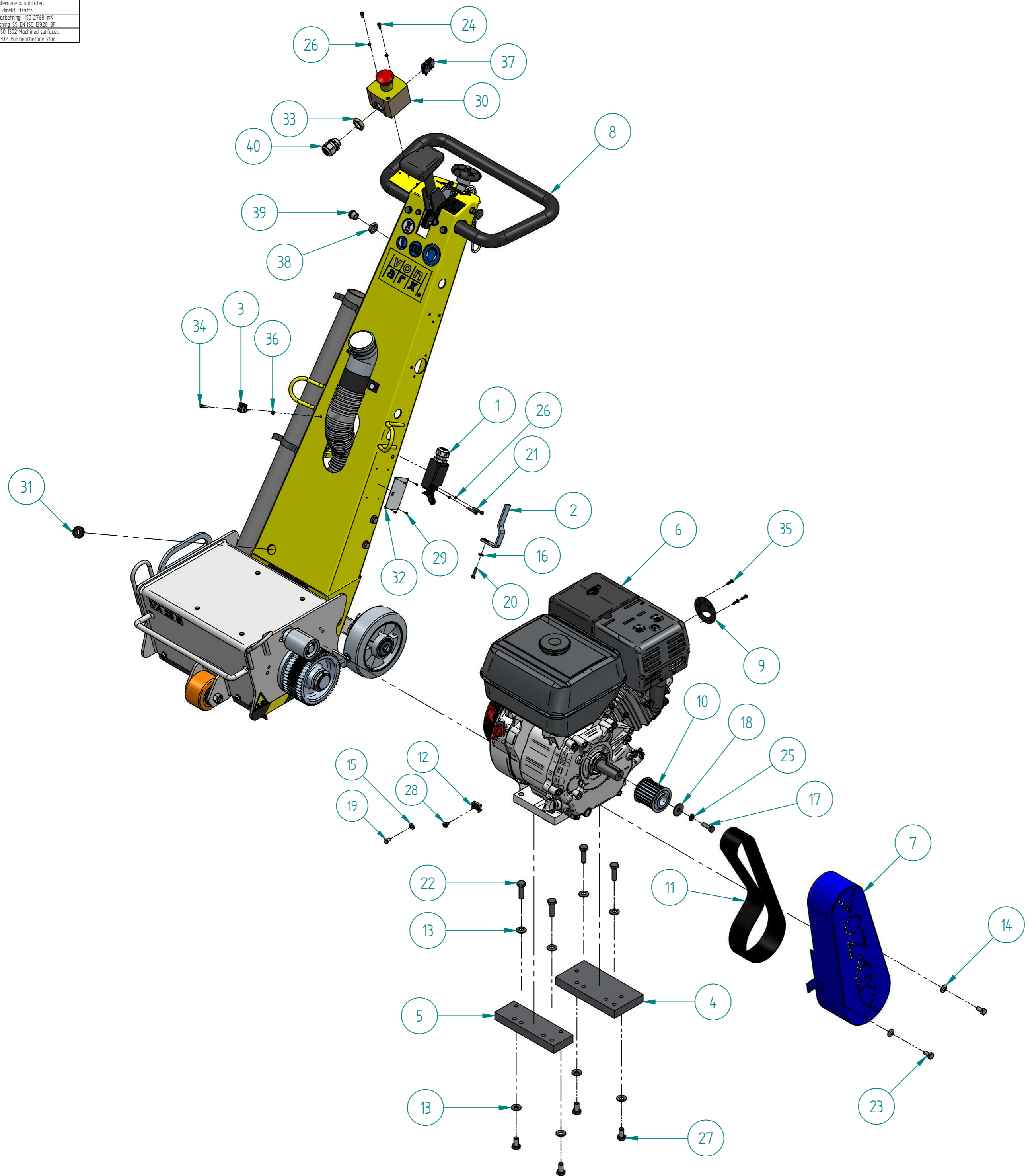

Item	Artikelnummer	Document Number	Title	Quantity
1	706365	665.32.00	POSITION SWITCH	1
2	703037	665.09.08a	BEVELLED PROFIL FOR SWITCH	1
3	702747	655.21.08	PIPE CLAMP WITH PROTECTION	1
4	702558	654.24.03b	ENGINE MOUNTING PLATE REAR	1
5	702557	654.24.02b	ENGINE MOUNTING PLATE FRONT	1
6	702556	654.24.01	GASOLINE ENGINE HONDA VA 25 S	1
7	702377	644.21.03c	BELT GUARD	1
8	702345	644.00.00	VA-25S BASIC DEVICE	1
9	701790	630.26.05	DEFLECTOR FOR HONDA	1
10	701533	628.0054a	TOOTHED PULLEY	1
11	109376	628.01.08	TOOTHED BELT 880-8MGT3-50	1
12	116783	BN_20275_TM3S25-C	SOCLE ASSEMBLY T+E	1
13	113919	BN_13292_M10	SAFETY WASHER	8
14	113918	BN_13292_M8	RIP-LOCK LOCKING WASHER	2
15	113917	BN_13292_M6	RIP-LOCK LOCKING WASHER	1
16	111366	BN_13292_M5	RIB-LOCK SAFETY WASHER	1
17	109668	BN_56_M8x25	HEXAGON HEAD SCREW	1
18	108580	BN_732	WASHER	1
19	107919	BN_56_M6x10	HEXAGONAL SCREW	1
20	107683	BN_56_M5x20	HEXAGON HEAD SCREW	1
21	102271	BN_3_M4x25	ALLEN SCREW	2
22	101609	BN_56_M10x35	HEXAGON HEAD SCREW	4
23	101599	BN_56_M8x16	HEXAGONAL SCREW	2
24	101590	BN_3_M4x10	ALLEN SCREW	2
25	100618	BN_762_M8	SPRING RING	1
26	100615	BN_792_M4	SAFETY WASHER	4
27	100614	BN_56_M10x20	HEXAGONAL SCREW	4
28	900049	BN_14064_6.3x13	PAN HEAD TAPPING SCREW	1
29	108214	BN_924_TAP_D320	POP RIVET TAP/D320	4
30	110942	791.80.04	CASING EMERGENCY STOP	1
31	109046	791.46.54	CABLE RETAINER	1
32	703559	788.42.31c	TYPE PLATE	1
33	114880		COUNTER NUT M20 PLASTICS	1
34	110955		HEX SOCKET CYLHEAD SCREW	1
35	108759		PARKER SCREW	3
36	108692		SELF-LOCKING HEXAGON NUT M4, DIN 985, FZB	1
37	111749		CONTACT TO EMERGENCY SHUTDOWN	1
38	115137		COUNTER NUT M16	1
39	115136		SELF-SEALING GROMMET	1
40	114813		SCREWED CABLE GLAND M20 PLAST	1
41	111183		STICKER "WARNING HOT SURFACE"	1
42	111181		STICKER 50MM	1
46	110890	791.80.03	SCOTCHLOK 3M	1
44	709394	788.42.28	ADHESIVE RED "CAUTION"	1
45	703556	788.42.27	STICKER	1
46	703555	788.42.26	ADHESIVE RED "ATTENTION"	1
47	900000		CABLE TIE 280X3.5, NATURAL	5
48	700603		TUBE MOLYKOTE BR2 PLUS	0.01
49	900042		LOCTITE 243	0.005

Material		Dimension	
Drawn By DD	Date 30.7.2019	Approved Date 14.11.2019	Approved By MS
Units : mm		SIZE A2	
		Description VA 25 S WITH GASOLINE MOTOR HO	Article Number 706124
		DWG NO 644.24.00	
Part/Assembly File 6442400.asm		sheet of 1 1	Rev. f

THE INFORMATION CONTAINED IN THIS DRAWING IS THE SOLE PROPERTY OF VON ARX. EXACT REPRODUCTION IN PART OR WHOLE WITHOUT THE WRITTEN PERMISSION OF VON ARX IS PROHIBITED.